



INSTRUCTION SHEET

Telescoping Stand

36" Cyclone Separators

#STZ360000

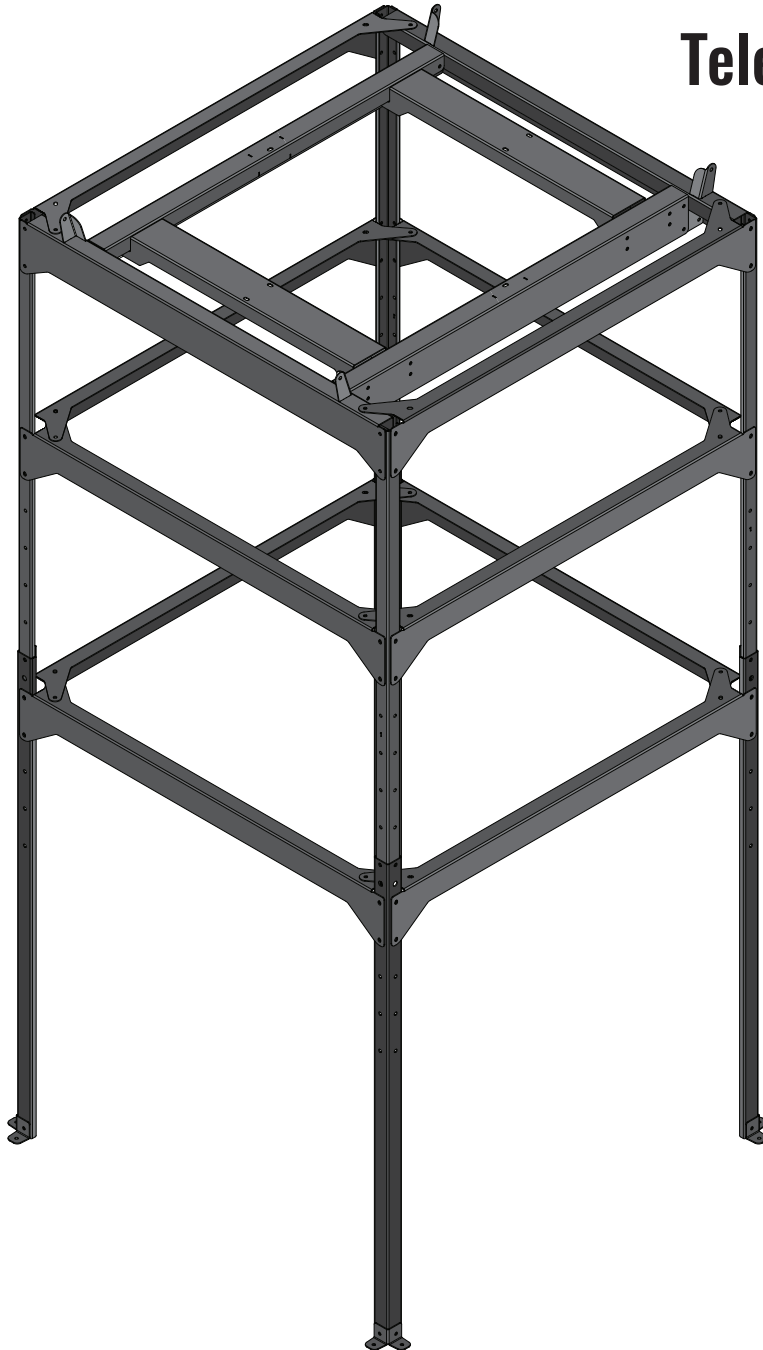

Actual appearance may vary to that shown above.

36" Stand Dimensions

Note: The Telescoping Stand has two mounting positions and the height will vary for each.

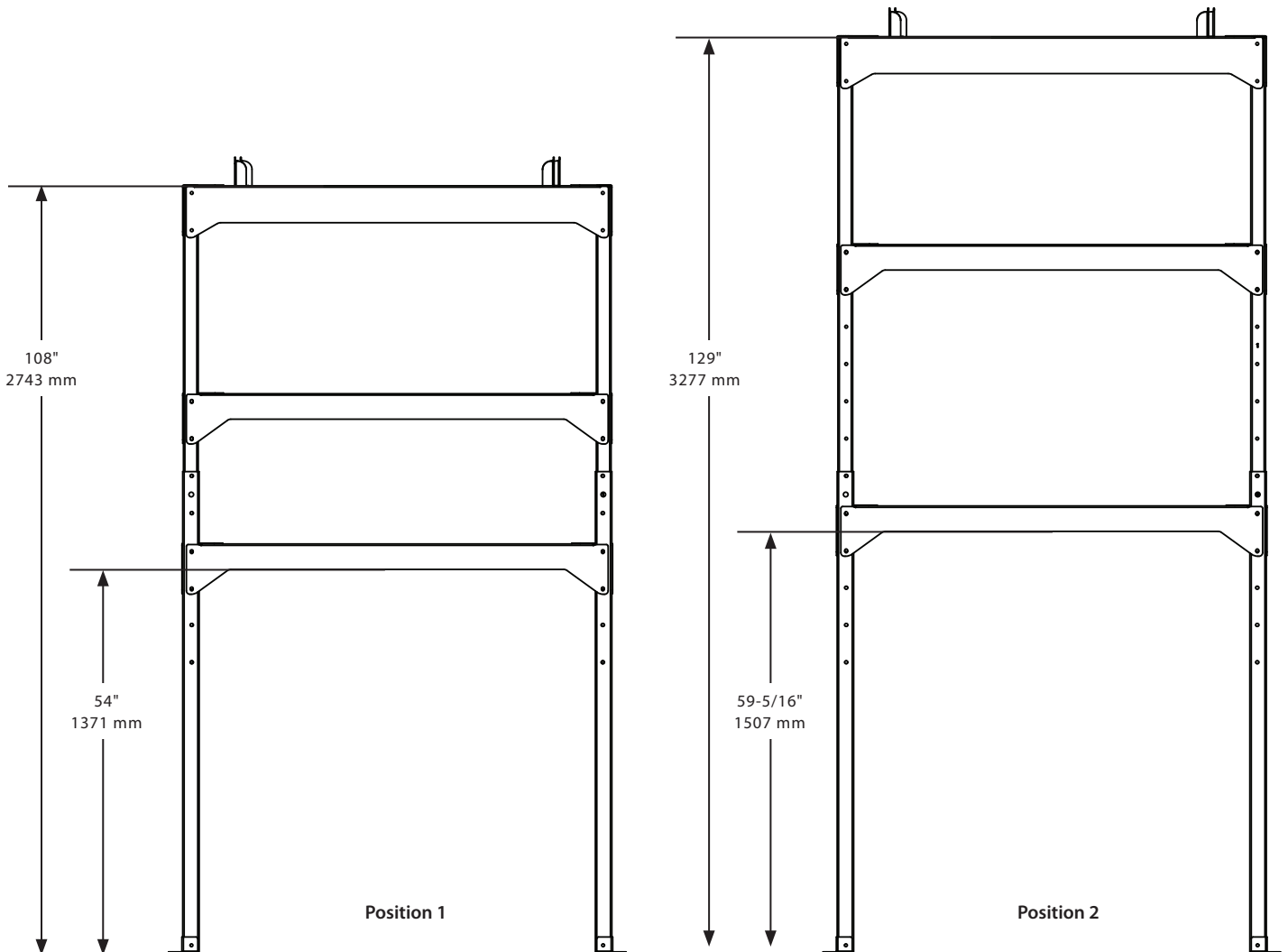
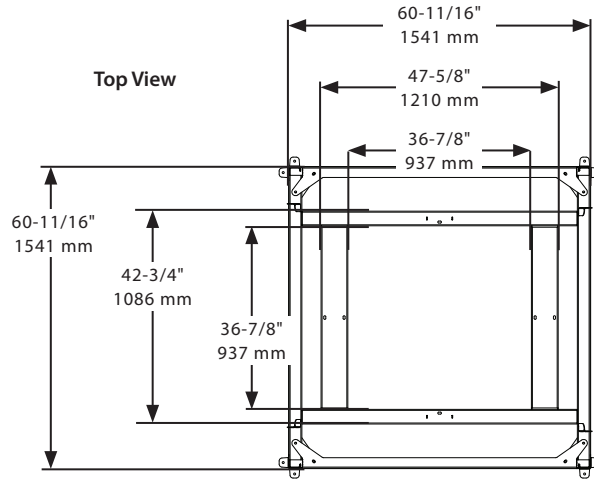

System Contents

ID	PART #	DESCRIPTION	QTY
A	STX360004	Top Telescoping Leg	4
B	STX360005	Bottom Telescoping Leg	4
C	STX360001	Stand Brace	10
D	STX360002	Cyclone Short Support Brace	2
E	STX360003	Cyclone Long Support Brace	2
F	FPB360001	Filter Plenum Support Brace	2

ID	PART #	DESCRIPTION	QTY
G	AHX360000	Stand Hardware Pack	1
G1	AFS015100	3/8-16 x 1" Hex-Head Bolt	116
G2	AFW190000	3/8" Flat Washer	232
G3	AFT900038	3/8-16" Nylock Nut	116
H	STX002002	Stand Foot	4

Please unpack the parts carefully and confirm you have received each item listed. There may be leftover hardware.

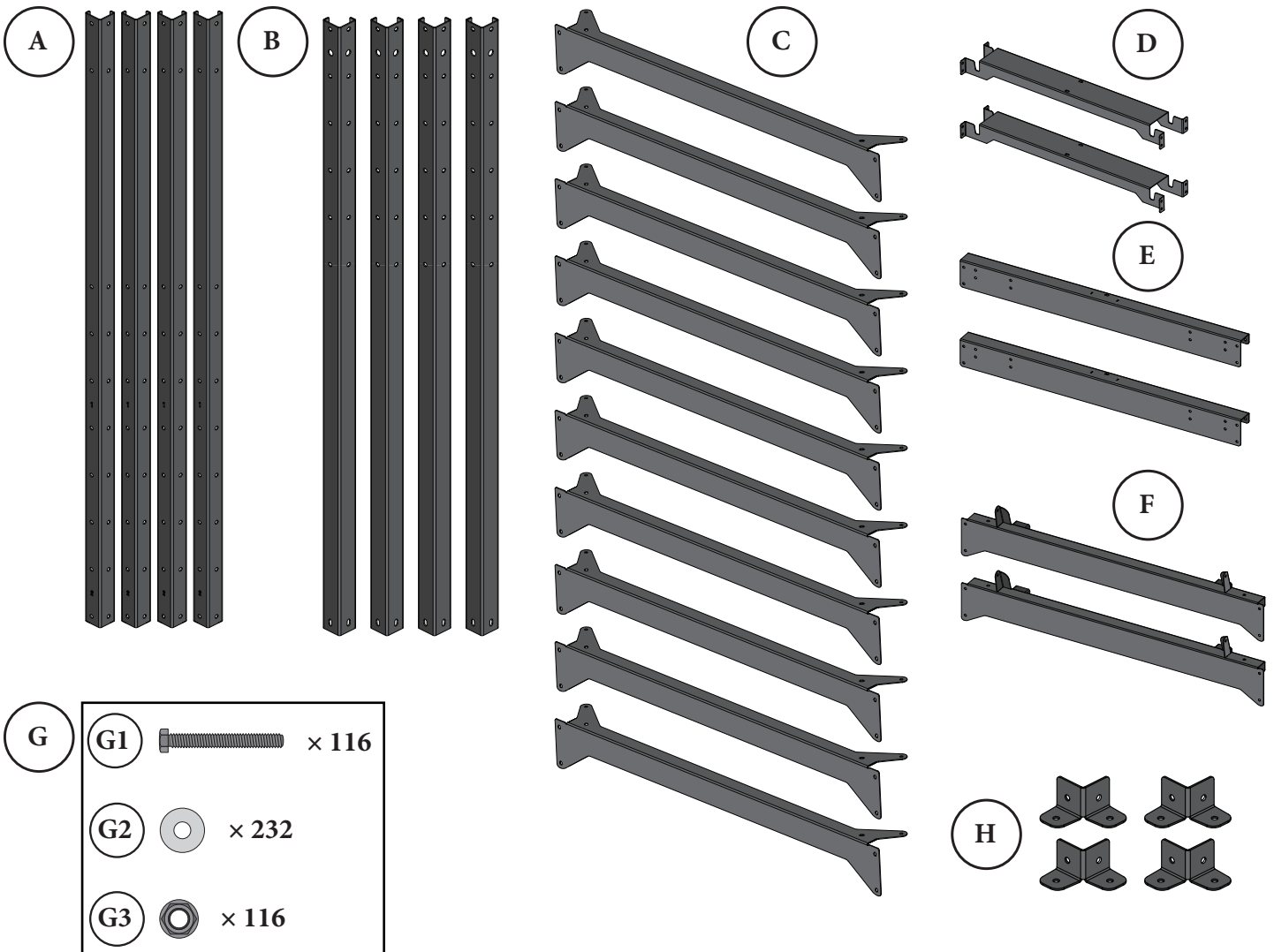

Assembly Instructions



THE TELESCOPING STAND SHOULD BE INSTALLED ON A FLAT, STABLE SURFACE CAPABLE OF SUPPORTING THE WEIGHT OF THE ENTIRE SYSTEM (INCLUDING FULL WASTE CONTAINERS) ONCE ASSEMBLED.

REQUIRED TOOLS		RECOMMENDED TOOLS
9/16" Wrench	Impact Driver	Leveling Tool
9/16" Socket Wrench		2x4 Blocks
Torque Wrench		

Note: We strongly recommend securing the Stand or Filter Option to the surface you are mounting it onto. You will need to supply your own mounting hardware (e.g. screws, washers, lag bolts, nuts, etc.).

- 1** Determine the location and orientation for your installation, taking careful note of which direction the dust collector's inlet and hanging filter plenum [FIG. 1a] or inverted filter plenum [FIG. 1b] will be facing.

Determine the required stand position [FIG 1b]:

- a. Position 1 is sufficient for most applications.
- b. Position 2 is recommended when more height is needed (e.g. when using an Air Lock and hopper).

Note: We recommend that the stand be assembled laying down and then raised into position later on.

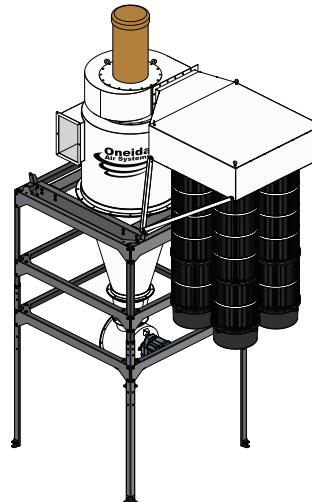

FIG. 1a

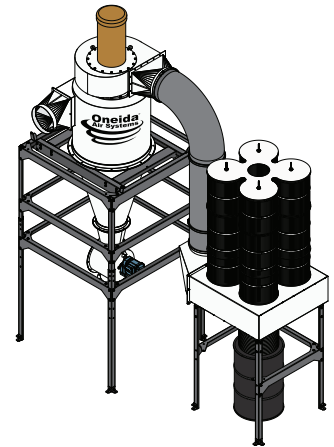
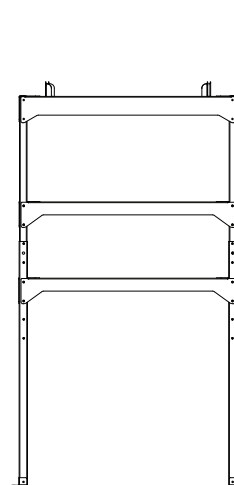
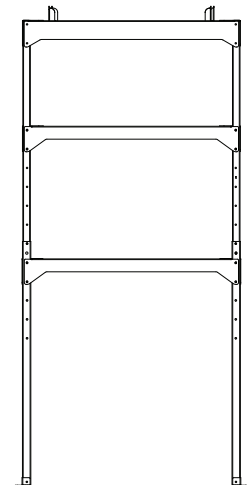

FIG. 1b



Position 1



Position 2

FIG. 1b

Assembly Instructions (Continued)

- 2 Identify the positioning hole on each of the Bottom Legs (B) and then slide a Top Leg (A) into each of the Bottom Legs until the desired position marker (#1 or 2) is shown inside the visible position marker [FIG. 2a].

Secure the two Legs together through the top positioning hole [FIG. 2a] using one Bolt (G1), two Washers (G2), and one Nylock Nut (G3) as shown in [FIG. 2b]. Loosely tighten only.

Repeat for each of the remaining Leg pairings until you have four Leg Assemblies.

Note: The stand will adjust to two different positions to accommodate varying waste containers (dual-drum, airlock, etc.). You will use the same position marker for each Leg. Loosely tighten only at this time.

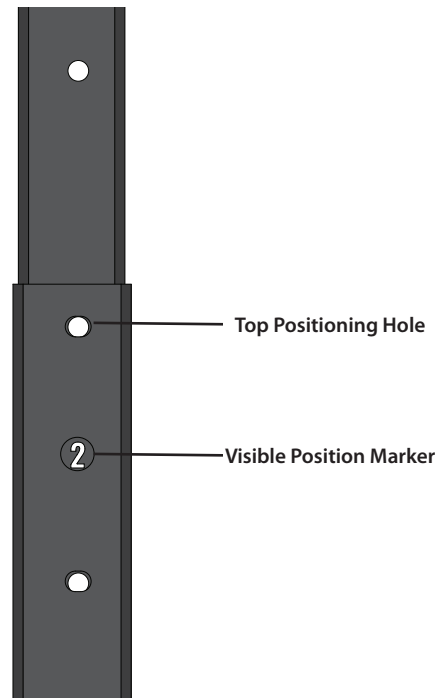

FIG. 2a

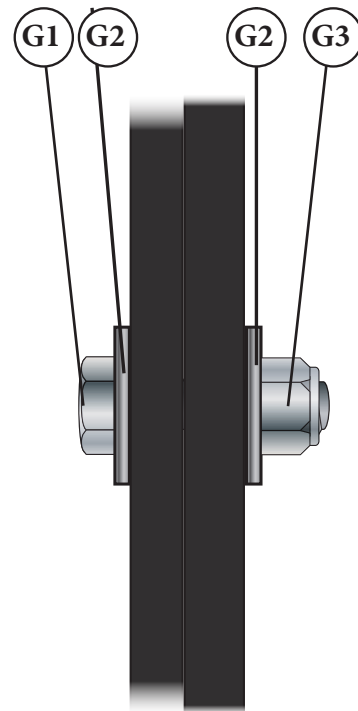

FIG. 2b

Assembly Instructions (Continued)

3

Place two Leg Assemblies from the previous step on the ground about 5' apart. Align the Leg Assemblies so the positioning holes are facing up. Lay one Filter Plenum Support Brace (F) and two Stand Braces (C) onto the Leg Assemblies to form the shape shown in [FIG. 3a]. Prop the Leg Assemblies (i.e. on 2x4 blocks) to allow for easier access when installing hardware.



FIG. 3a

Secure the Filter Plenum Support Brace to the Leg Assemblies using four Bolts (G1), eight Washers (G2), and four Nylock Nuts (G3) [FIG. 3b].

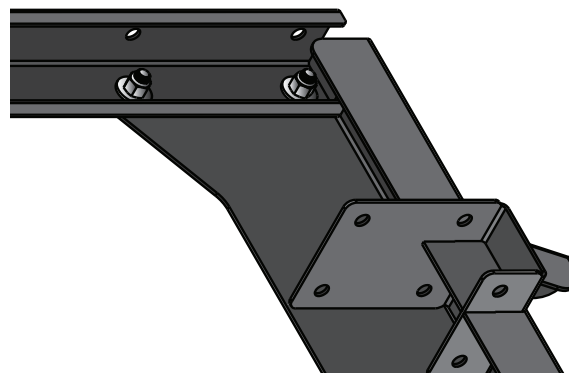

FIG. 3b

Secure the two Stand Braces to the Leg Assemblies using eight Bolts, sixteen Washers, and eight Nylock Nuts [FIG. 3c].

Note: Loosely tighten only at this time.

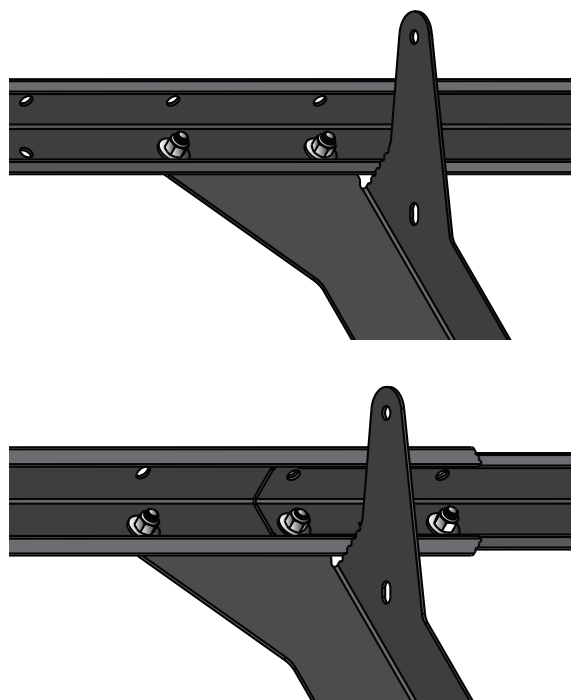

FIG. 3c

Assembly Instructions (Continued)

4

Secure three Stand Braces (C) to each side of the Leg Assembly using four Bolts (G1), eight Washers (G2), and four Nylock Nut (G3) [FIG. 4a] [FIG. 4b].

Note: The top most Stand Braces will only use three Bolts, six Washers and three Nylock Nut [FIG. 4c]. Loosely tighten only at this time.

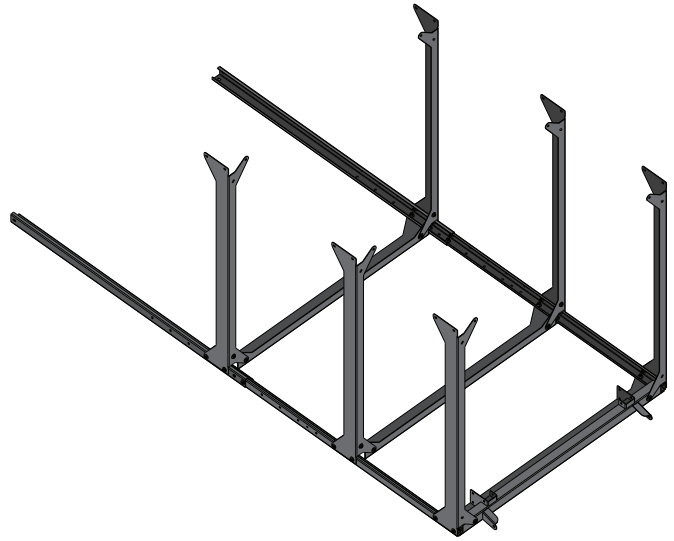

FIG. 4a

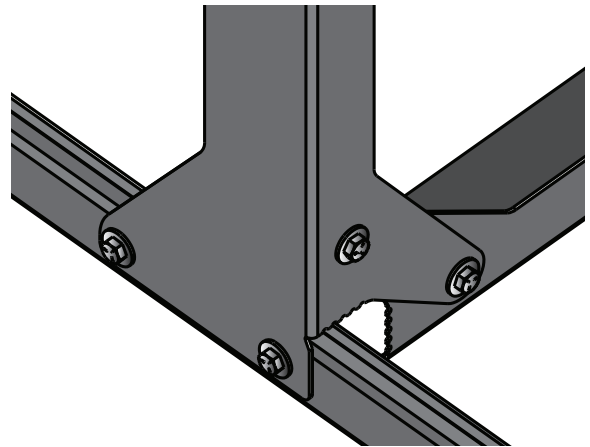

FIG. 4b

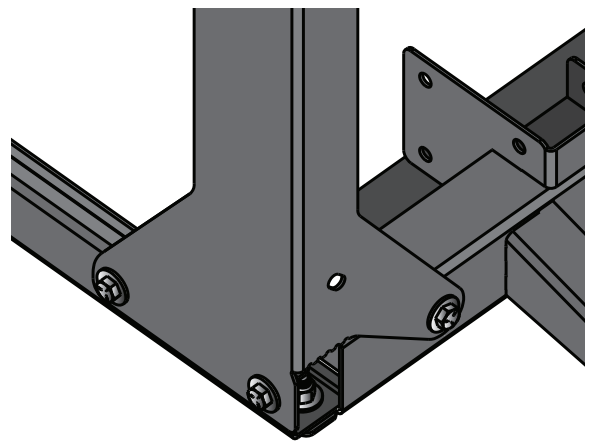

FIG. 4c

Assembly Instructions (Continued)

5

Attach the two remaining Leg Assemblies to each end of the previously installed Stand Braces (C) as shown in [FIG. 5a]. Ensure that all Leg Assemblies are attached in matching positions.

Secure each Leg Assembly to the six Stand Braces using twelve Bolts (G1), twenty-four Washers (G2), and twelve Nylock Nut (G3) [FIG. 5b].

Note: Loosely tighten only at this time.

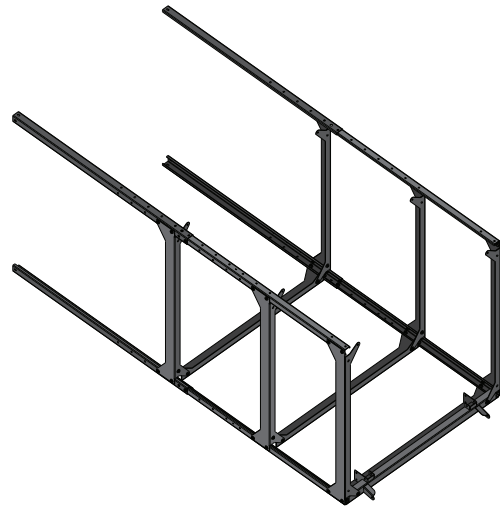

FIG. 5a

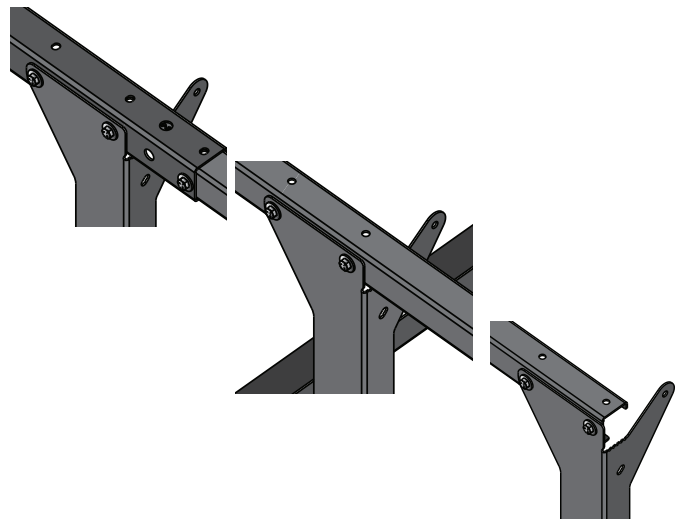

FIG. 5b

6

Secure two Stand Braces (C) and one Filter Support Braces (F) to each side of the installed Leg Assemblies using four Bolts (G1), eight Washers (G2), and four Nylock Nut (G3) [FIG. 6].

Note: The top most Stand Braces will only use three Bolts, six Washers and three Nylock Nut. Loosely tighten only at this time.



FIG. 6

Assembly Instructions (Continued)

7

Align the three holes at the end of each Long Support Brace (E) to the stand assembly so that they slide over the Plenum Support Braces (F). Secure each Long Support Brace with six Bolts (G1), twelve Washers (G2), and six Nylock Nut (G3).

Align the four holes at the end of each Short Support Brace (D) to the four holes on the Long Support Braces (E). Secure each Short Support Brace with eight Bolts (G1), sixteen Washers (G2), and eight Nylock Nut (G3)[FIG. 7a][FIG. 7b].

Note: Loosely tighten only at this time.

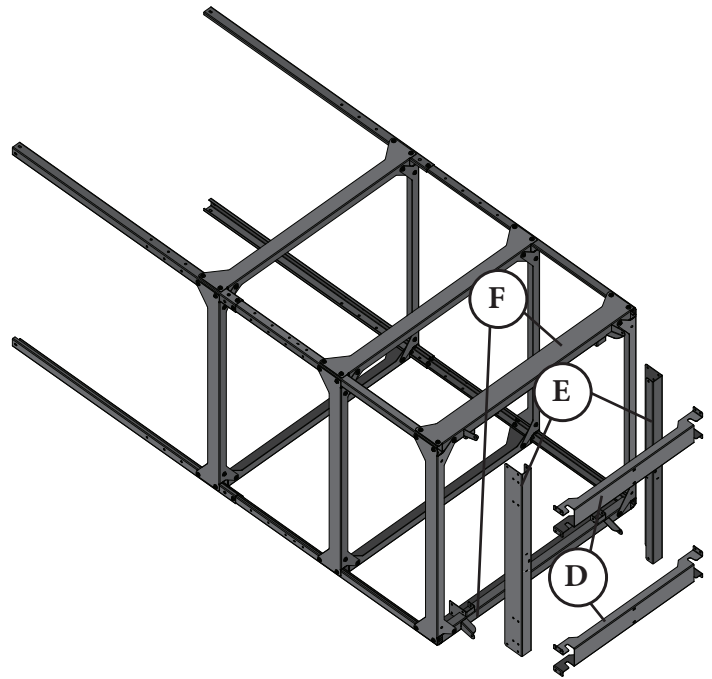

FIG. 7a



FIG. 7b

Assembly Instructions (Continued)



THE TELESCOPING STAND CAN BECOME QUITE HEAVY ONCE FULLY ASSEMBLED AND MAY SHIFT SLIGHTLY WHEN BEING MOVED. WE RECOMMEND HAVING AT LEAST TWO PEOPLE AVAILABLE TO HELP LIFT THE STAND INTO PLACE.

8

Raise the Stand up and ensure that all components are squared and level before tightening the hardware [FIG. 8].

We recommend torquing all of the bolts down to 325 in.-lbs. (~27 ft.-lbs.).



FIG. 8

9

Attach a Stand Foot (H) to the bottom of each Leg Assembly. Secure the Foot in place using two Bolts (G1), four Washers (G2), and two Nylock Nut (G3) [FIG. 9].

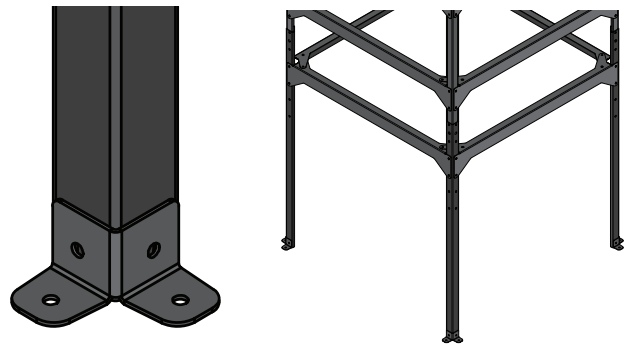

FIG. 9

10

We strongly recommend that the Stand is bolted down to the floor through the holes in the Stand Feet (H) [FIG. 10].

Note: You will need to supply your own hardware (e.g. screws, washers, lag bolts, etc.) for securing the system to the floor.

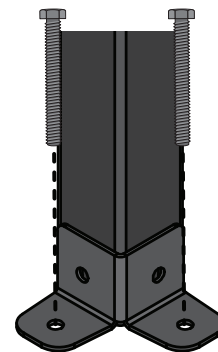

FIG. 10



The **Industry Leader in Dust Collection**

Thank you for your business!

Regardless of where you purchased your system, if you have any questions or issues with missing / damaged parts, please call Oneida Air Systems first to let us help resolve your problem. We fully stand behind the quality of our product and place the utmost value on each customer's satisfaction.

We want to do everything possible to make your purchase and experience with Oneida Air Systems a good one!

Customer Service Dept.

1-866-387-8822 • support@oneida-air.com

1001 West Fayette Street, Syracuse, NY 13204 U.S.A.

Copyright © 2021 Oneida Air Systems, Inc.