



INSTRUCTION SHEET

Wall Bracket

V-Systems

SMS180000B



System Dimensions

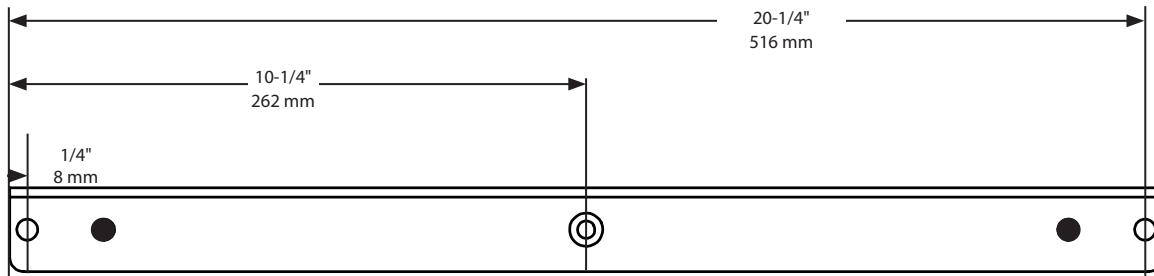

Back Support Brace

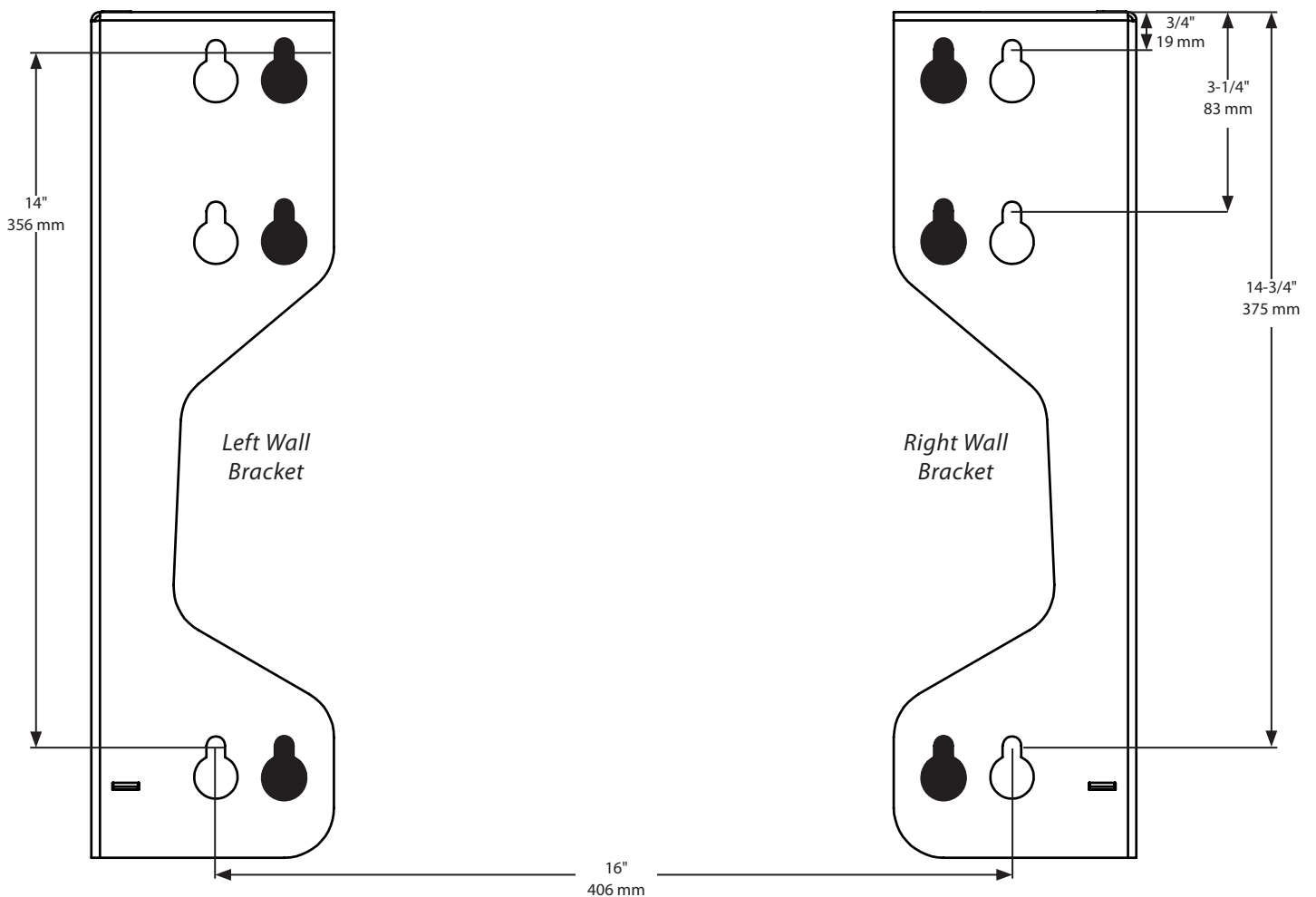

Note: The Wall Bracket is universal to 18" and 21" systems. The blackened holes on the Back Support Brace and Left and Right Wall Brackets in the images above will not be utilized in the V-System installation.

System Contents

ID	Part number	Part description	Qty	ID	Part number	Part description	Qty
A	RBW182103	Back Support Brace	1	E	AHX182100	Wall Bracket Hardware Kit	1
B	RBW182102	Left Wall Bracket	1	E1	AFS516500	5/16" x 1/2" Hex Head Bolt	2
C	RBW182101	Right Wall Bracket	1	E2	AFW180000	5/16" Flat Washer	2
D	DFZ180001	Angle Ring Flange	1	E3	AFT155175	5/16"-18 Whiz-Lock Nut	2

Please unpack the parts carefully and confirm you have received each item listed here.

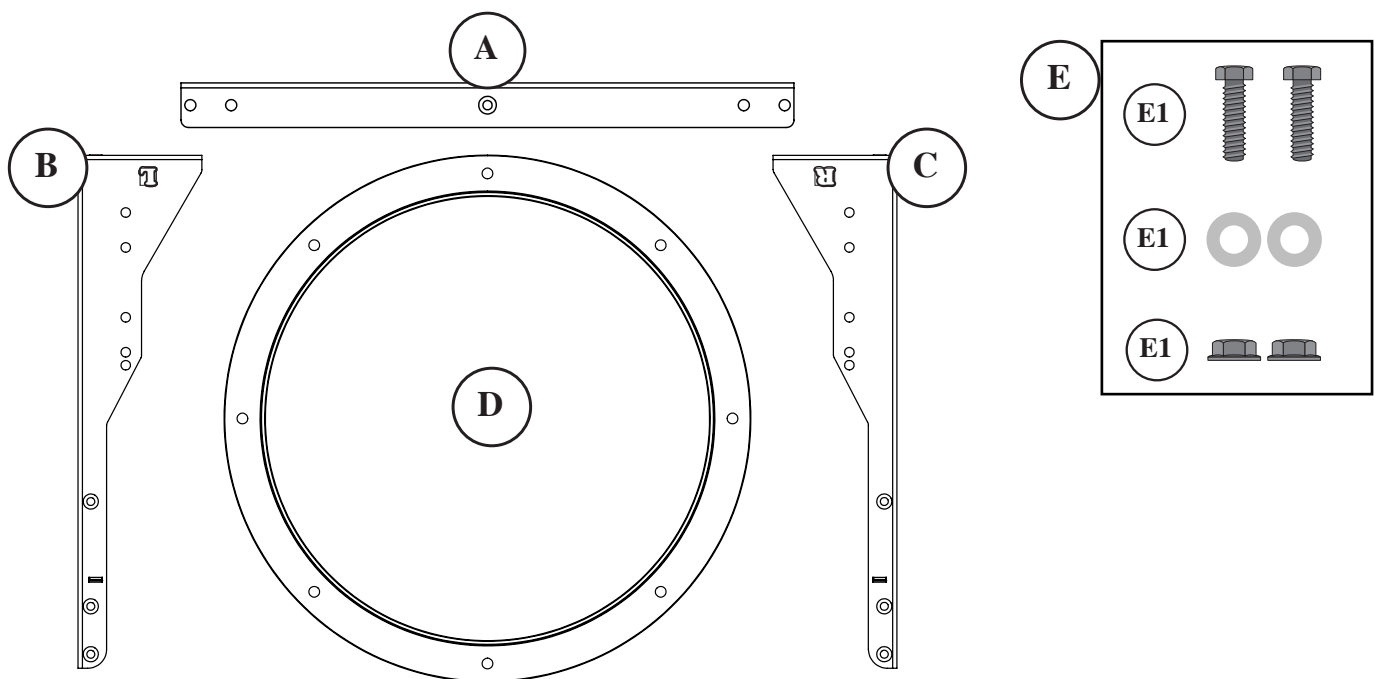

You will need the following tools:

WALL MOUNTING BRACKET			
Stud Finder	Light Adhesive Tape	1/2" Wrench	Clamp
Tack / Center Punch / Nail	Tape Measure / Ruler	1/2" Socket Wrench	Power Drill
Wall Mounting Fasteners *	Level Tool	Pencil / Marker	Drill Bit (for your wall fastener)

*You will need to supply your own wall mounting hardware. Use appropriate fasteners for the wall type you are installing your system onto (e.g. lag bolts, drywall anchors, etc.). Maximum Fastener Diameter: 5/16". Maximum Washer Outside Diameter: 3/4".

Assembly Instructions



THE WALL BRACKET SHOULD BE MOUNTED TO A STURDY, REINFORCED WALL (E.G. CONCRETE WALL, WOOD-FRAMED WALL, ETC.) THE WALL BRACKET IS DESIGNED TO WORK WITH STANDARD 16" STUD SPACING. WALL ANCHORS CAN BE USED IF MOUNTING ON DRYWALL. THE INCLUDED TEMPLATE INDICATES THE PROPER DRILL HOLES AND THE FULL, ASSEMBLED SIZE OF THE WALL BRACKET.

1

Center the Wall Bracket Template between your wall studs.

2

Mark a straight level line on the wall 54.5" (35-gallon drum) or 66.5" (55-gallon drum) from the floor.
Note: If you have the Drum Dolly, mark a straight level line on the wall at 58.6" (35-gallon drum) or 70.625" (55-gallon drum) above the floor.

3

Temporarily secure the template to the wall with a tack or non-marking tape. Align the top of the template with the line previously marked.

4

Place a mark or drill through the paper at each indicated cross hair. Remove the template from the wall.

5

Use appropriate fasteners for the wall type you are installing your system onto.

- a. Maximum Fastener Size: 5/16" diameter
- b. Maximum Washer Size: 3/4" outside diameter

6

Drill into the wall at all 6 of the marked locations.

7

Place washers onto each fastener and thread the fasteners into all 6 holes, leaving at least 1/2" outside of the hole. [FIG 1]

FIG. 1

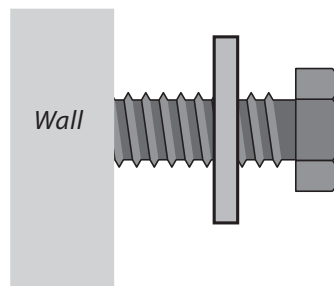

Assembly Instructions (Continued)

- 8** Lift the Right Wall Bracket (C) up and over the three fasteners on the right so that the washer is on the outside of the bracket. [FIG 2a] [FIG 2b]

FIG. 2a

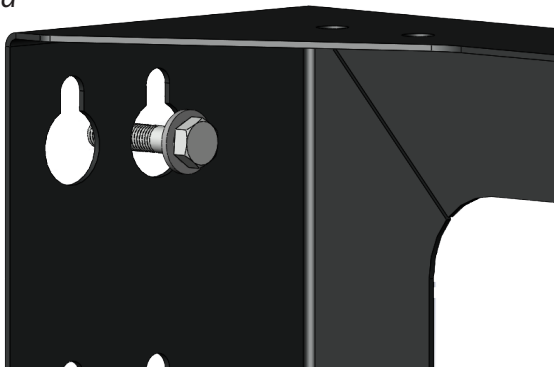
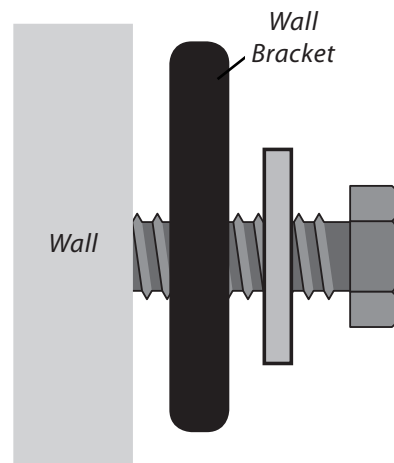
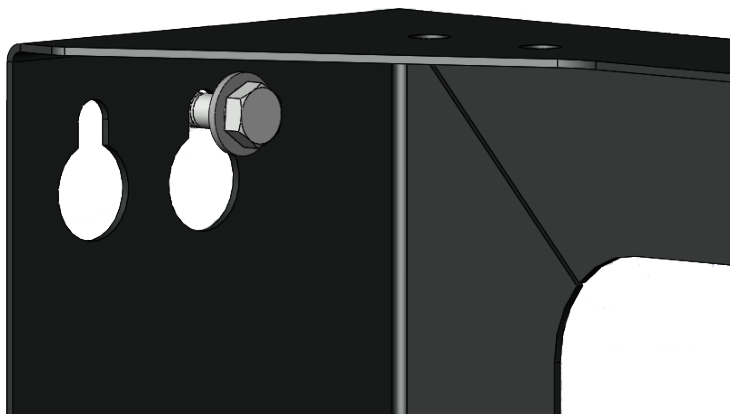

FIG. 2b



- 9** Slide the bracket down so that the fastener is in the smaller section of each keyhole [FIG 3].

FIG. 3



- 10** Tighten these three fasteners to secure the Right Wall Bracket (C) to the wall.

- 11** Repeat steps 8-10 for the Left-Wall Bracket (B).

Assembly Instructions

- 12** Secure Back Support Brace (A) under both Side Brackets (B)(C) with two Bolts (E1), two Flat Washers (E2), and two Whiz-Lock Nuts (E3) – finger tighten only. [FIG 4] See Step 13 for alternate positions.

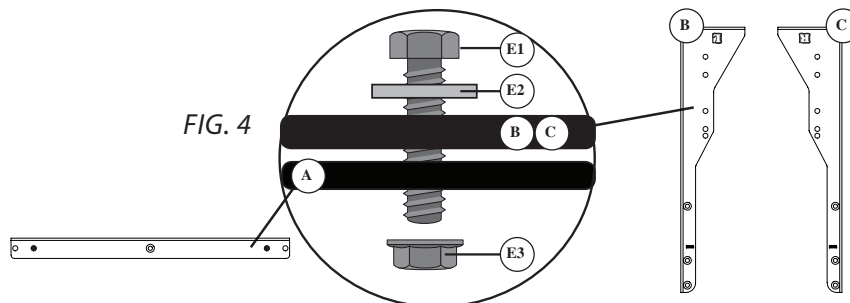

- 13** The Back Support Brace (A) can be attached in two positions to accommodate your preferred V-System orientation. To have the system closest to the wall refer to [FIG 5a] and [FIG 5b] and to have the filter or ductwork parallel to the mounting wall refer to [FIG 5c] and [FIG 5d]. For this mounting position, the bolts must be placed as shown in [FIG. 5e]. For additional examples of filter and inlet orientation, refer to page 8 of the V-System Owner's Manual (ZBM000101A).

FIG. 5a
Top View: Closest to wall position

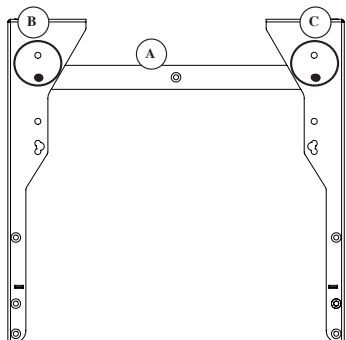

FIG. 5b
Top View: Closest to wall position

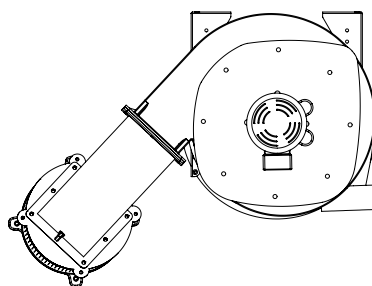

FIG. 5c
Top View: Parallel to wall position

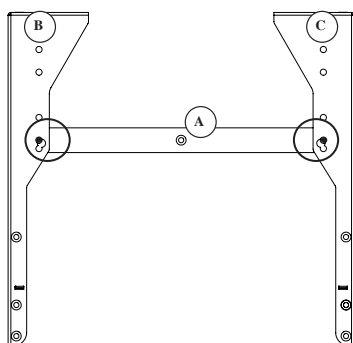

FIG. 5d
Top View: Parallel to wall position

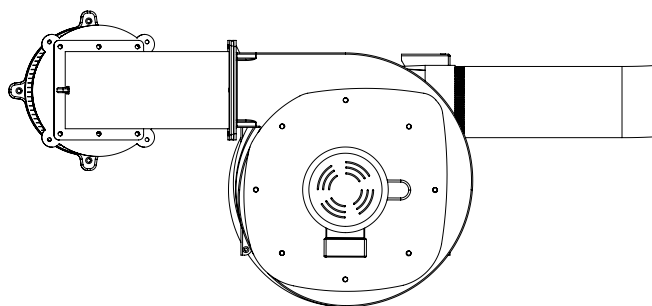
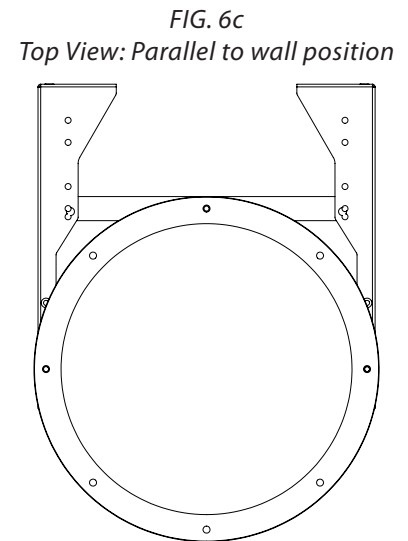
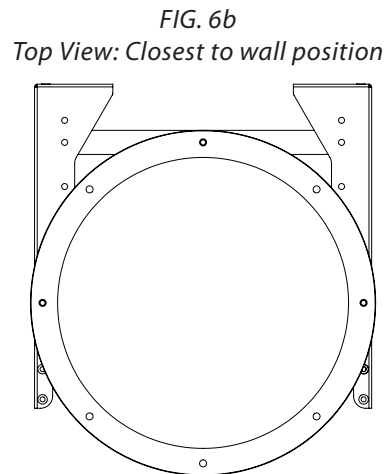
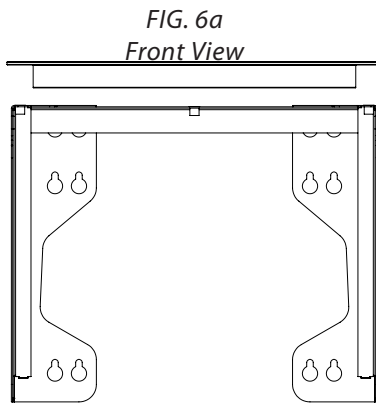

FIG. 5e
Bolt placement
shown in black



Assembly Instructions

- 14** Place the Angle Ring (D) pointing downward onto the assembled Wall Brackets (B, C) and Back Support Brace (A) and align it with the corresponding holes [FIG 6a] [FIG 6b] [FIG 6c].



- 15** Firmly tighten the wall fasteners and the Back Support Brace bolts.
- 16** Insert the V-System's cone into the Angle Ring on the Wall Bracket Assembly [FIG. 7]. Refer to Step 5 of the V-System Owner's Manual (ZBM000101A) for further instructions.

FIG. 7
Front View

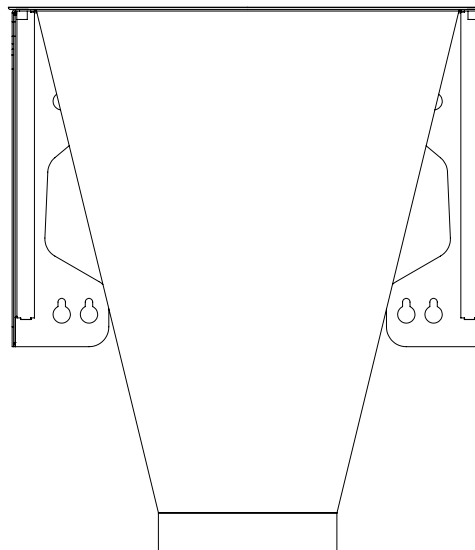



The **Industry Leader in Dust Collection**

Thank you for your business!

Regardless of where you purchased your system, if you have any questions or issues with missing / damaged parts, please call Oneida Air Systems first to let us help resolve your problem. We fully stand behind the quality of our product and place the utmost value on our customer's satisfaction.

We want to do everything possible to make your purchase and experience with Oneida Air Systems a good one!

Customer Service Dept.

1-866-387-8822 • support@oneida-air.com

1001 West Fayette Street, Syracuse, NY 13204 U.S.A.

Copyright © 2019 Oneida Air Systems, Inc.