



OWNER'S MANUAL

Onboard Cyclonic Pre-Separator Attachment

XXP500000-P



Appearance may vary slightly

Table of Contents

System Dimensions Installed Extended.....3

System Contents..... 4

Assembly Instructions..... 6

Troubleshooting.....11

Warranty Information..... 13

Notes.....14

System Start-Up Information



READ THE SAFETY PRACTICES INSTALLATION AND MAINTENANCE INSTRUCTIONS AND YOUR WET/ DRY VACUUM'S OWNER'S MANUAL BEFORE ASSEMBLING AND USING THE DUST DEPUTY

1. Do not vacuum anything that is burning or smoking, such as cigarettes, matches, hot ashes, or any hot substance!
2. Do not vacuum (or use this cyclone near) flammable or combustible liquids, gases, or explosive dusts, such as gasoline or other fuels, lighter fluid, cleaners, oil-based paints, natural gas, hydrogen, coal dust, magnesium dust, grain dust, aluminum dust, sugar dust, flour dust or gun powder.
3. To reduce the risk of health hazards from vapors or dusts, do not vacuum toxic materials unless a HEPA filter is used. Do not use or store near hazardous materials.
4. Dust can be flammable and explosive. Some dust can be toxic or cause allergic reactions.
5. Wood dust mixtures are highly flammable and can be explosive. NEVER introduce sparks or sources of ignition into collector.
 - a. Dump drum after each use.
 - b. Ground system.
6. NEVER leave wood dust in a building or vehicle.
7. Keep fire extinguishers handy at all times.
8. Can be used for collecting non-flammable liquids.
9. Dispose of waste in a FIRE SAFE AREA.



SOME DUSTS ARE HIGHLY FLAMMABLE OR EXPLOSIVE. LEARN / KNOW WHAT YOU ARE DEALING WITH. FOLLOW ALL LOCAL, STATE, FEDERAL & NFPA CODES AND GUIDE LINES.

Customer Service Dept.

1-866-387-8822 • support@oneida-air.com

System Dimensions Installed Extended

Nominal dimensions shown. Dimensions subject to slight variations in manufacturing.

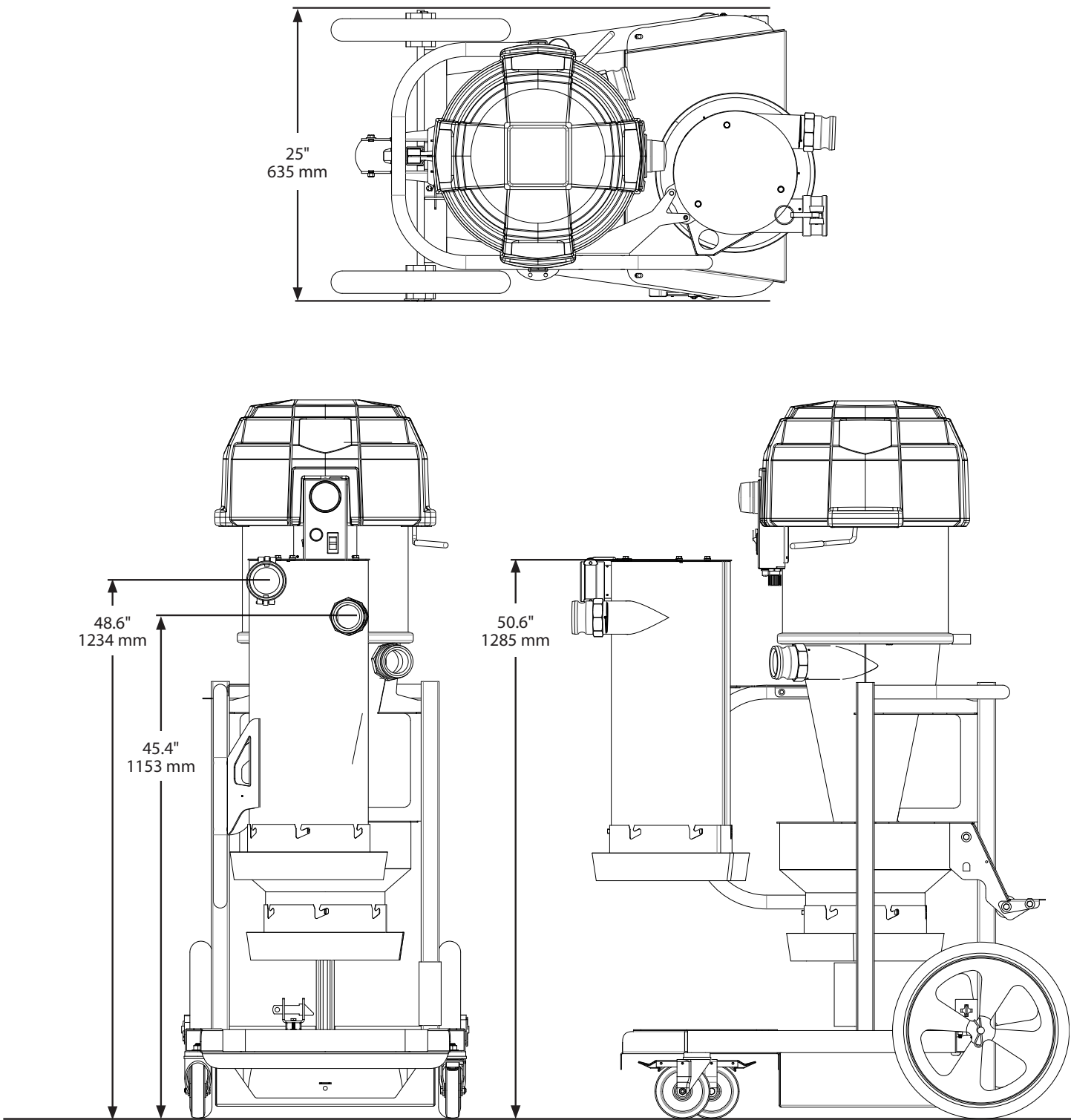

System Contents



If you cannot find an item on the list, examine the packaging materials very carefully for nested items. Please note that certain components have been pre-installed. There may be hardware leftover.

ID	Part number	Part description	Qty
A	SCX001501	Onboard Cyclonic Pre-Separator	1
B	SSL001500	Longopac Cassette Holder	1
C	RBC000500	Pre-Separator Dust Pan	1
D	AHX000024	Hardware Pack	1
D1*	RLH000023	23 mm Button Plug	1
D2	STX000004	Top Support Brace	1

ID	Part number	Part description	Qty
D3	AFB155175	5/16-18 x 3/4" Hex Head Bolt	2
D4	AFT900516	5/16" - 18 Nylock Nut	2
D5	AFB155195	5/16-18 x 2" Hex Head Bolt	4
D6	AFB155155	5/16 - 18 x 1" Flange Bolt	2
E	AXH000500	2" x 5' Cam and Groove Vacuum Hose	1
F	AFE000001	40" Bungee Cord with J Hooks	1

Please unpack the parts carefully and confirm you have received each item listed here.

* Some components are pre-installed at the factory and are listed here for your convenience.

You will need the following tools:

7/16" Wrench	3/8" Wrench
7/16" Socket Wrench	#2 Phillips-Head Screw Driver
1/2" Wrench	Flathead Screw Driver
1/2" Socket Wrench	Putty Knife
Scissors	Box Cutter

System Contents (Continued)

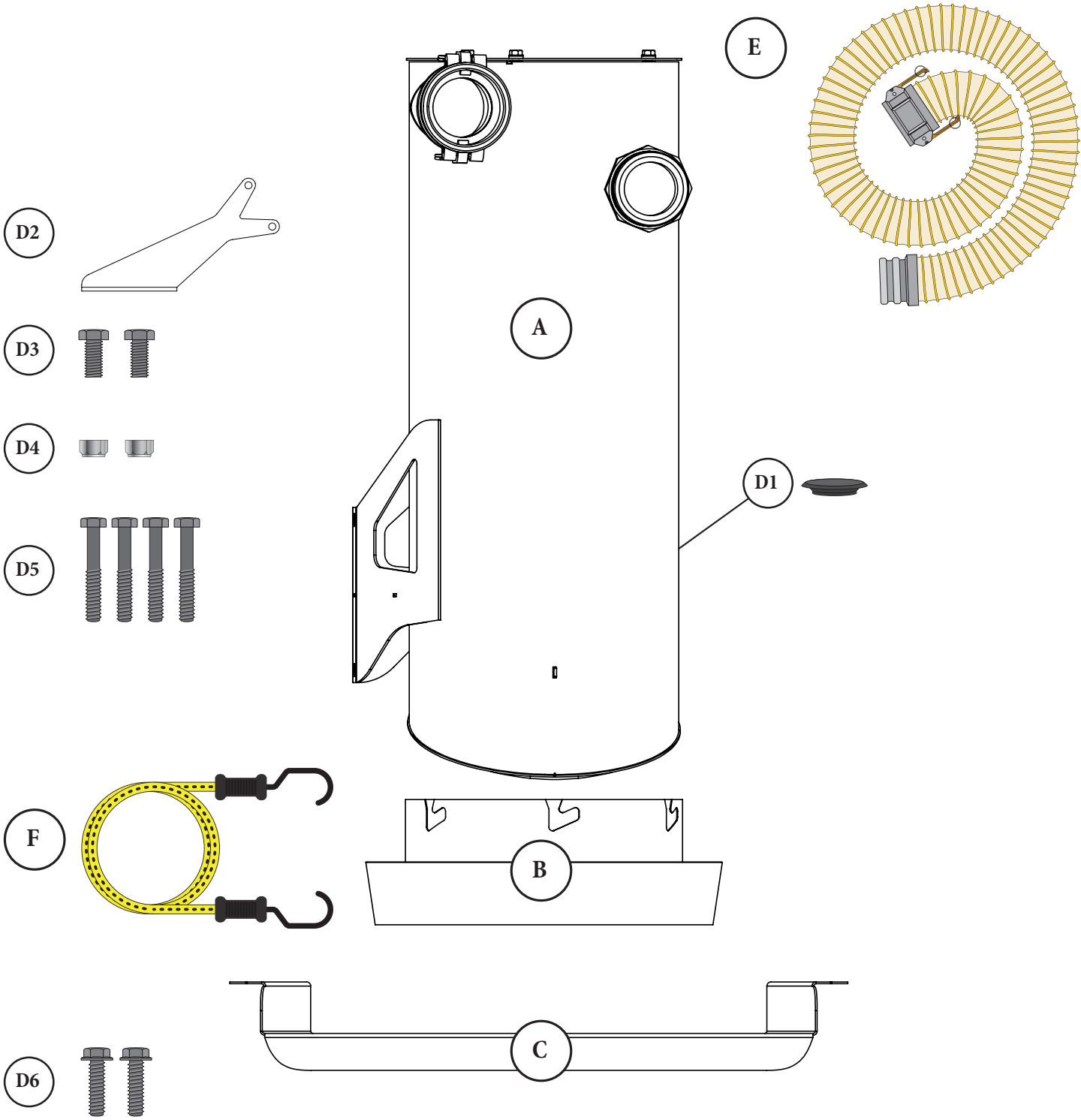

Assembly Instructions

- 1 Secure the Pre-Separator Dust Pan (C) to the threaded inserts on the CC500's cart using two Flange Bolts (D6) [FIG. 1].



FIG. 1

- 2 Remove the eight plastic caps from both sides of the CC500's handle assembly [FIG. 2].
Note: Use a flat, non-marking tool to remove the caps if they are inserted too tightly.

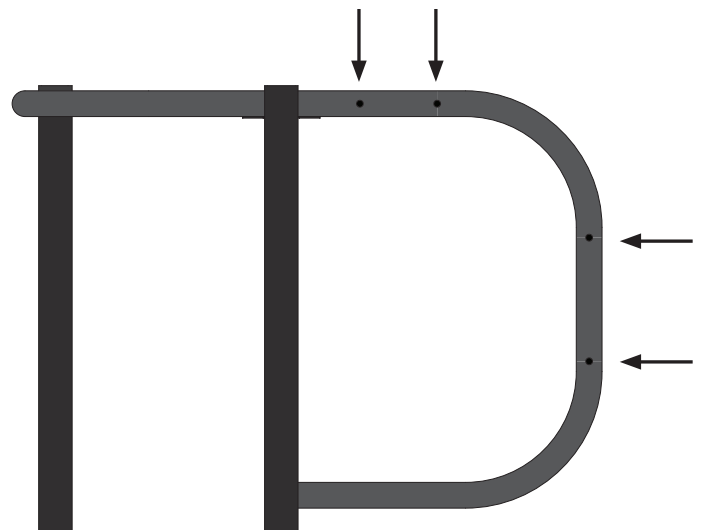

FIG. 2

Assembly Instructions (Continued)

3

Align the Top Support Brace (D2) to the two top holes on the CC500's handle and secure in place using two 2" Hex Head Bolts (D5) as shown in [FIG. 3]

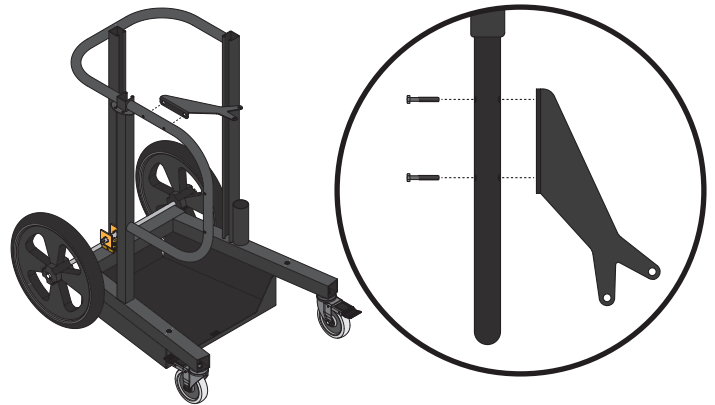

FIG. 3

4

Align the Cyclonic Pre-Separator's (A) side support brace to the side holes on the CC500's handle and secure in place using two 2" Hex Head Bolts [FIG. 4]

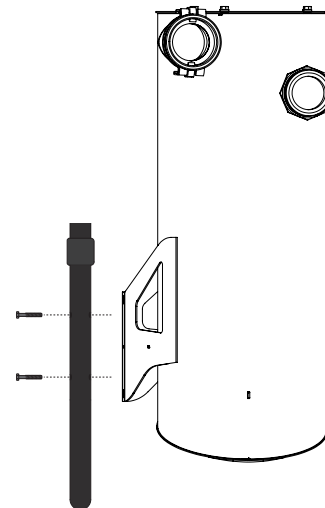

FIG. 4

5

Secure the Cyclonic Pre-Separator (A) to the previously installed Top Support Brace (D1) using two 3/4" Bolts (D3) and Nylock Nuts as shown in [FIG. 3]

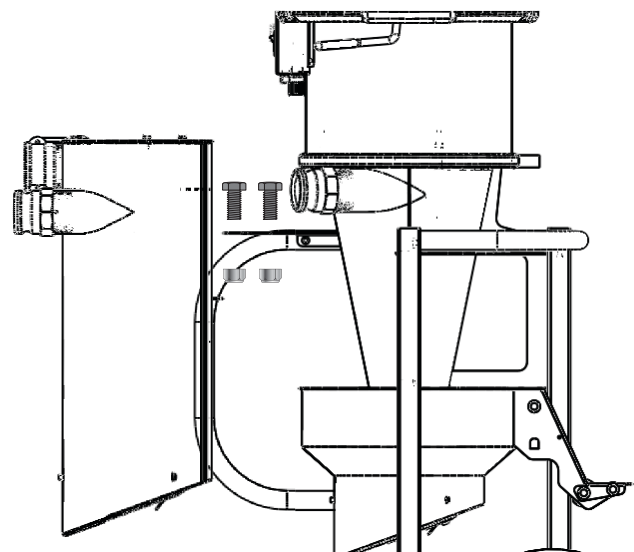

FIG. 5

Assembly Instructions (Continued)

6

Install one of the CC500's cassettes into the Cassette Holder (B) pushing it down so that it is snug and even on all sides [FIG. 6].

Note: For ease of assembly, do not cut the ties used to hold the cassette together until noted.

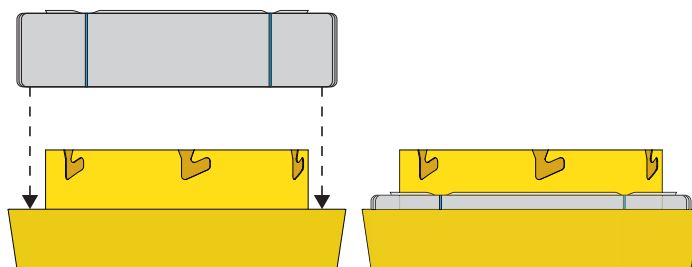

FIG. 6

7

Align the tabs on the Cyclonic Pre-Separator (A) with the cutouts in the Cassette Holder (B) [FIG. 7a]. Raise the Cassette Holder (B) up until the tabs are engaged then twist the Cassette Holder (B) counter clockwise to lock it in place [FIG. 7b] [FIG. 7c].

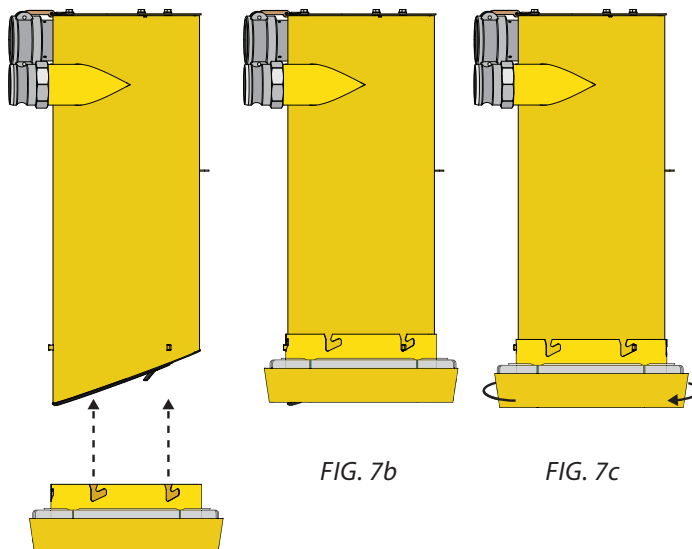

FIG. 7a

FIG. 7b

FIG. 7c

8

Cut off and discard the twist ties on the cassette. Pull the center of the Cassette up and over the bead of the Cyclonic Pre-Separator (A). Secure to the hopper using the Bungee Cord (F) [FIG. 8].

Note: Take caution when cutting off the twist ties so that you do not puncture the cassette.

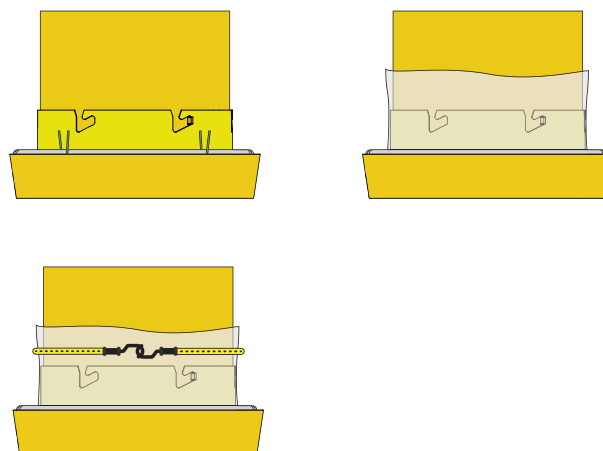

FIG. 8

Assembly Instructions (Continued)

9

Pull the outside of the cassette over and down the lip of the Cassette Holder (B) and tie the bag off with a zip tie [FIG. 9a].

Note: Remaining zip ties can be stored in a convenient retaining cylinder at the bottom of the cart [FIG. 9b].

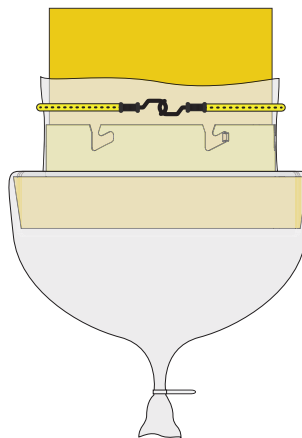

FIG. 9a

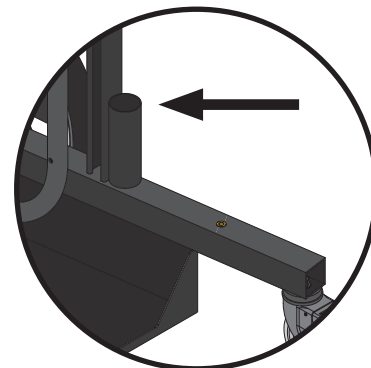

FIG. 9b

10

Connect the Cyclonic Pre-Separator (A) to the CC500 with the Cam and Groove Vacuum Hose (E) by inserting the male portion of the coupling into the female coupling. Pull the levers on the side to secure in place

Connect the CC500 to your tool using the included 2" x 25' Cam and Groove Vacuum Hose. Secure the hose in place using levers on the side [FIG. 11].

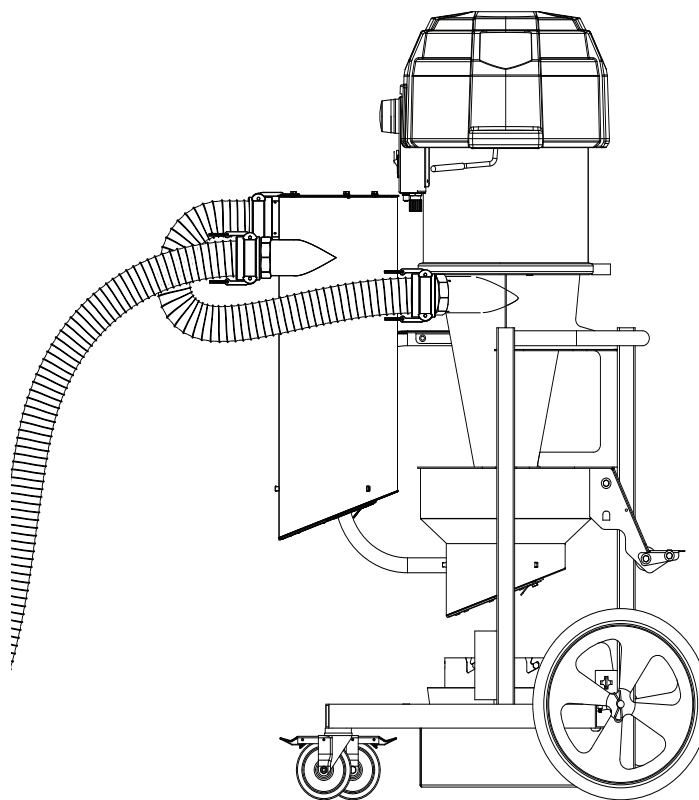

FIG. 10

Maintenance (Continued)

Emptying the Bag

When first using the dust extractor, check the Longopac regularly to get an idea of how often it needs to be emptied.

1. The bag cassette is sealed at one end with a cable tie. once the bag starts to fill up, pull it down and new material is drawn from the cassette to make the bag longer.
2. To make a new bag, pull the material down and seal it at the top with a cable tie.
3. Add another cable tie above the first one and cut the bag material off between the two cable ties.

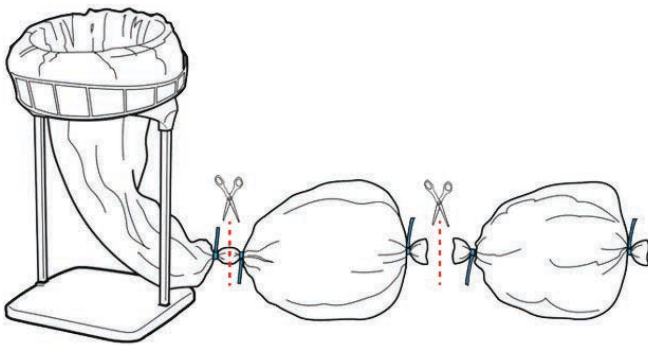

7. Reinstall the lid.

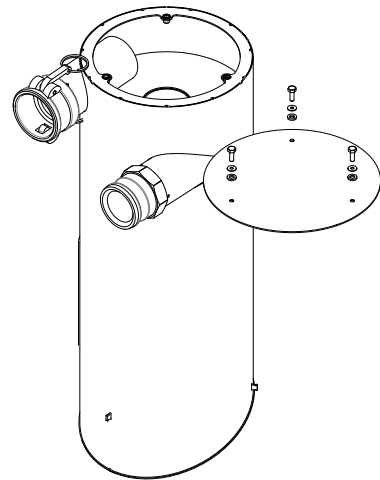

Cleaning out the V-Tube

If the bag and hopper becomes overfilled and the cone is packed with dust:

1. Wear a dust mask and eye protection.
2. Turn off the dust extractor and wait for the fan blower to come to a complete stop and for the dust to settle before unlatching the drum from the cyclone body.
3. Try to get contents of cone to fall down into hopper an Longopac Mini cassettes. Empty Longopac Mini cassettes and reinstall as directed. If the pre-separator is packed so that dust won't flow down into the drum on it's own then remove the top lid.
4. Remove the three 1/4" bolts, washers and rubber washers and set aside. Remove the lid. The top of the pre-separator can now be accessed to allow debris to drop down into the drum/bin.
5. Use a lengthy rod to push dust and debris down.
6. Check the lid's gasket for damage.

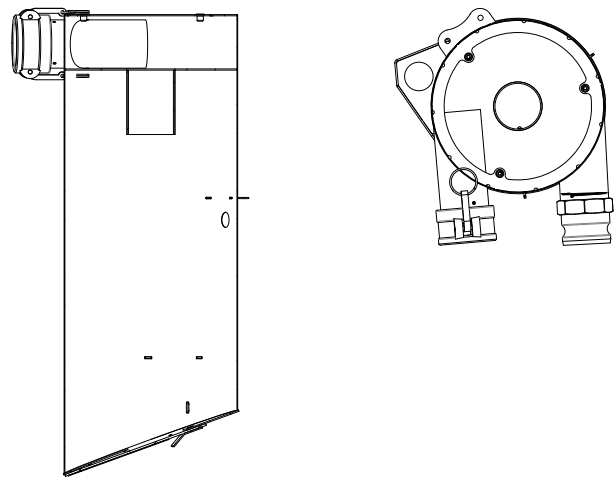

Troubleshooting

PROBLEM	CAUSE	SOLUTION
Not separating well. (Only a tiny amount of dust should reach the vacuum)	Air leaks in the drum	<ol style="list-style-type: none">1. Check for leaks between the lid and the dust drum.2. Check for holes or leaks in the dust drum.3. Check for leaks along the flange of the cyclone.
Material swirls in cyclone and won't drop into the dust container.		
Material swirls in cyclone and won't drop into the dust container.	Collecting large bulky material	<ol style="list-style-type: none">4. Large, bulkier material might swirl. Restart or temporarily cut off air flow to drop material down.
Low Air Volume	System clogged	<ol style="list-style-type: none">5. Clean vacuum and the vacuum filter per the manufacturer's specs.6. Check all hose connections for a blockage in the hose.



If you continue to experience difficulty with your dust collector, call Oneida Air Systems' Customer Service Department at 1-866-387-8822 or email support@oneida-air.com.

Recommended Accessories (Continued)



4x Longopac Mini Bag Cassettes

#FBL010570

- Innovative Longopac system to allow for customizable bag sizes and virtually eliminate dust exposure when tying off bags for disposal.
- 14" x 14" x 196'



2" x 25' CC500 Flex-Hose

#AHX902501

- Heavy-duty, abrasion resistant flex hose designed for use with high-pressure systems.
- Constructed from thick polyurethane and reinforced with a wire helix.
- Perfect when using a single connection to switch between multiple tools.



Capacitive Dust Sentry

#AXB991002

- Alerts tool operators when their dust bin is full using an adjustable sound wave sensor - suitable for any type of dust or material, particularly fine powders such as silica dust!
- Installs easily onto your extractor or pre-separator.
- Includes high visibility strobe light to indicate fill level in noisy work environments.



CDD-L Cyclonic Pre-Separator w/ Longopac

#AXD000002-HD-L

- Features our patented steel Dust Deputy® cyclone separator - up to 99% efficient with wood dust and over 90% with concrete/silica dust.
- Aids with OSHA compliance to new Silica Dust Safety Standards.
- Compatible with Longopac Mini bagging system for customizable dust bag sizes - eliminates dust exposure to operator when emptying.



CDD-14 Cyclonic Pre-Separator w/ 14 Gal. Bin

#AXD000002-HD-14

- Features our patented steel Dust Deputy® cyclone separator - up to 99% efficient with wood dust and over 90% with concrete/silica dust.
- Aids with OSHA compliance to new Silica Dust Safety Standards.
- Lightweight, 14 gallon dust bin with viewing window and liner bag retainer system (5 free bags included).

Warranty Information

Limited Warranty – Activate online at oneida-air.com/warranty

Oneida Air Systems®, Inc. (OAS) warrants the Supercell for a period of 1 year, to the original purchaser from the date of purchase, unless otherwise specified. Items not manufactured by Oneida Air Systems are limited to their own manufacturer's warranties. All electrical items such as magnetic starters, remotes, sensors, pumps, bin sensors, bag grippers, etc. and accessories are limited to 90 days. Oneida Air Systems warrants that the product will be free from defects in materials and workmanship.

This is Oneida Air Systems' sole written warranty and any and all warranties that may be implied by law, including any merchantability or fitness, for any particular purpose, are hereby limited to the duration of this written warranty. Oneida Air Systems does not warrant or represent that the merchandise complies with the provisions of any law or acts unless the manufacturer so warrants. This warranty does not apply to defects due directly or indirectly to misuse, negligence, accidents, abuse, repairs, alterations, improper wiring or lack of maintenance. In no event shall Oneida Air Systems' liability under this warranty exceed the purchase price paid for the product and any legal actions brought against Oneida Air Systems shall be tried in the State of New York, County of Onondaga.

The buyer is cautioned to install and operate Dust Collectors in accordance with prescribed Federal, State, OSHA, NFPA, local codes and regulations. This equipment should be installed/wired by a licensed electrician following all applicable codes. Local codes can be significantly different from national codes. The customer assumes the responsibility for contacting their insurance underwriter with regard to specific application requirements of venting or if additional fire protection and safety equipment may be required. Oneida Air Systems shall in no event be liable for death, injuries to persons or property or for incidental, and contingent, special, or consequential damages arising from the use of our product.

Oneida Air Systems makes every effort to accurately represent our products and prices, however Oneida Air Systems reserves the right to make changes to products and prices at any time. As a manufacturer, Oneida Air Systems reserves the right to change product specifications at any time in an effort to achieve better quality products.



ONEIDA AIR SYSTEMS SHALL IN NO EVENT BE LIABLE FOR DEATH, INJURIES TO PERSONS OR PROPERTY, OR FOR INCIDENTAL AND CONTINGENT, SPECIAL, OR CONSEQUENTIAL DAMAGES ARISING FROM THE USE OF OUR PRODUCT.

SAFETY WARNING - PLEASE READ

Before Purchasing or Installing a dust collection system the buyer is cautioned to do so in accordance with prescribed Federal, State, Local, OSHA, NFPA, and any other applicable codes or regulations relating to the type of dust(s) you are collecting.

SOME TYPES OF DUST UNDER CERTAIN CONDITIONS HAVE THE POTENTIAL TO BE EXPLOSIVE.

Oneida Air Systems is not responsible for how the dust collector is used or installed. Dusts with deflagration or explosion risks, such as wood dust, may require additional safety equipment including but not limited to; venting, spark detection, suppression systems, back draft dampers or may require installation in an outside location or in a protected area away from personnel. The customer assumes the responsibility for contacting their insurance underwriter with regard to specific engineering controls or application requirements. (We suggest you reference NFPA 664, 654 and 68 codes for more information) Oneida Air Dust Collection Systems may not be suitable for some applications and are not designed to be used in explosive atmospheres. Oneida Air Systems equipment should only be installed and wired by a licensed electrician following all applicable local and national electrical codes.

Some dust created by power sanding, sawing, grinding, drilling, and other construction activities contains chemicals known to cause cancer, birth defects or other reproductive harm. Some examples of these chemicals are: Lead from lead-based paints; Crystalline silica from bricks, cement and other masonry products; Arsenic and chromium from chemically-treated lumber; etc.

Your risk from these exposures varies, depending on how often you do this type of work. To reduce your exposure to these chemicals, work in a well ventilated area, and work with approved safety equipment, such as those dust masks that are specially designed to filter out microscopic particles. Oneida Air Systems recommends using additional approved safety equipment such as an approved OSHA and NIOSH dust mask or respirator.

Oneida Air Systems makes every effort to accurately represent our products, specifications and prices; however Oneida Air Systems reserves the right to make changes to products and prices at any time. As a manufacturer, Oneida Air Systems reserves the right to change product designs and specifications at any time.

[illegible]



The **Industry Leader in Dust Collection**

Thank you for your business!

Regardless of where you purchased your system, if you have any questions or issues with missing / damaged parts, please call Oneida Air Systems first to let us help resolve your problem. We fully stand behind the quality of our product and place the utmost value satisfaction of our customers.

We want to do everything possible to make your purchase and experience with Oneida Air Systems a good one!

Customer Service Dept.

1-866-387-8822 • support@oneida-air.com

1001 West Fayette Street, Syracuse, NY 13204 U.S.A.

Copyright © 2019 Oneida Air Systems, Inc.